

Item description/product images

**Description****Material:**

Housing high-strength aluminium.
Stop system steel.

Version:

Housing anodised.
Stop system hardened and black oxidised.

Note:

Maintenance-free pneumatic linear modules with recirculating ball bearing guide and load capacity of max. 240 N. Control by 4/2 or 5/2 directional valve. pneumatic drive, 4-8 bar, constant, filtered (10 µm), dried, oiled or unoled. Compressed air connection M5.

Modules of the same size can be combined with one another without adapter plates via the precise centring system by means of centring rings 20240.

The position of the stop system is variable.

Repeat accuracy ± 0.01 mm.

Accessory:

See table for shock absorbers, proximity switches and plug connectors.

Drawing reference:

- 1) compressed air connections
- 2) counterbore for socket head screw ISO 4762-M6
- 3) screw cannot be installed by 30/75/125/175 travel

Drawings

Load data

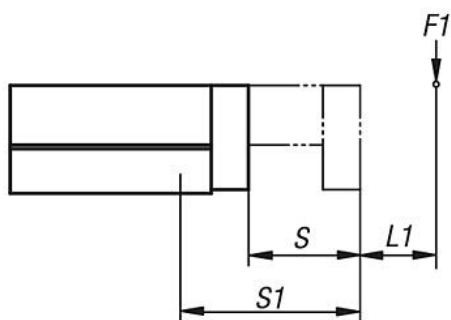

$$M1 = (S1 + L1) \times F1$$

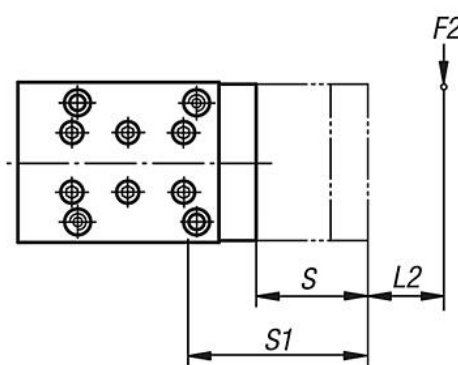

$$M2 = (S1 + L2) \times F2$$

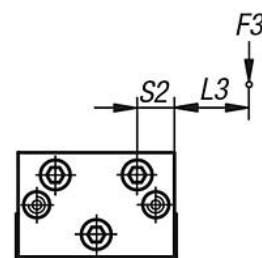

$$M3 = (S2 + L3) \times F3$$

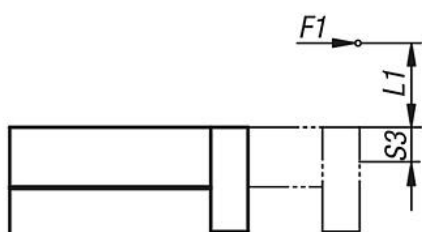

$$M1 = (S3 + L1) \times F1$$

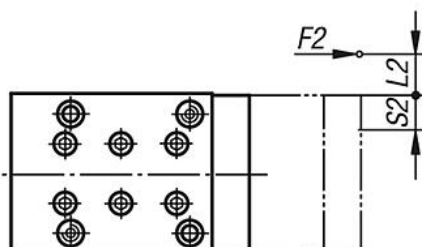

$$M2 = (S2 + L2) \times F2$$

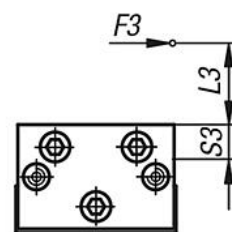

$$M3 = (S3 + L3) \times F3$$

$$\frac{M1_{eff}}{M1_{zul}} + \frac{M2_{eff}}{M2_{zul}} + \frac{M3_{eff}}{M3_{zul}} \leq 1$$

Calculating the lifespan:

$$L = \left(\frac{M_{zul}}{M_{eff}} \right)^3 \times 10^5$$

L = lifespan (m)

M_{zul} = permissible torque (Nm)

M_{eff} = calculated torque (Nm)

Overview of items

Order No.	Size	E	E1	E2	E3	L	Travel S	Load capacity N	Piston force at 6 bar (N)	Retraction force at 6 bars (N)	Cylinder Ø	Air consumption per cycle at 6 bar (ccm)
20036-6030	6	1 x 48	29	36	18	121	30	240	76	66	16	11,2
20036-6050	6	1 x 48	29	36	18	121	50	220	76	66	16	18,7
20036-6075	6	2 x 48	35	42	21	175	75	200	76	66	16	28

Overview of items

Order No.	Size	E	E1	E2	E3	L	Travel S	Load capacity N	Piston force at 6 bar (N)	Retraction force at 6 bars (N)	Cylinder Ø	Air consumption per cycle at 6 bar (ccm)
20036-6100	6	2 x 48	35	42	21	175	100	180	76	66	16	37,4
20036-6125	6	3 x 48	17	45	27	231	125	160	76	66	16	46,8
20036-6150	6	3 x 48	17	45	27	231	150	140	76	66	16	56,1
20036-6175	6	4 x 48	26	52	34	288	175	120	76	66	16	65,5
20036-6200	6	4 x 48	26	52	34	288	200	100	76	66	16	74,8

Order No.	Size	M1 Nm	M2 Nm	M3 Nm	S1	S2	S3
20036-6030	6	33,2	33,2	44,6	45 + S/2 (travel)	14	16
20036-6050	6	33,2	33,2	44,6	45 + S/2 (travel)	14	16
20036-6075	6	38,7	38,7	59,5	70 + S/2 (travel)	14	16
20036-6100	6	38,7	38,7	59,5	70 + S/2 (travel)	14	16
20036-6125	6	44,2	44,2	59,5	95 + S/2 (travel)	14	16
20036-6150	6	44,2	44,2	59,5	95 + S/2 (travel)	14	16
20036-6175	6	49,7	49,7	74,4	120 + S/2 (travel)	14	16
20036-6200	6	49,7	49,7	74,4	120 + S/2 (travel)	14	16