

Item description/product images



Description

Material:

Steel.

Version:

Plastic coated.

Note:

The traction sleeve with inner tube is a replacement part for the indexing plungers with remote actuation 03096-10.

On request:

Special lengths.

Accessory:

Wire cable with ball 03096-15.

End sleeve 03096-25.

Setscrew 03096-30.

Screw nipple 03096-35.

Hex nut 07212.

Drawings

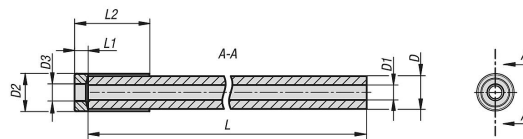

Overview of items

Order No.	Main material	Surface finish body	D	D1	D2	D3	L	L1	L2
03096-20-0150X1000	steel	plastic-coated	5	2,2	5,5	2,5	1000	2	11
03096-20-0150X3000	steel	plastic-coated	5	2,2	5,5	2,5	3000	2	11
03096-20-0150X5000	steel	plastic-coated	5	2,2	5,5	2,5	5000	2	11