

Item description/product images



Description

Material:
Thermoplastic.

Version:
Black, grey or red.

Note:
Suitable screws ISO 4762.

Δ Add the desired colour code here.
No colour code is required for black.

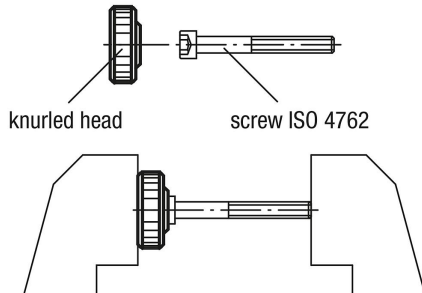

press the screw into the head

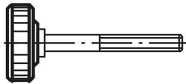

knurled head with male thread



Drawings

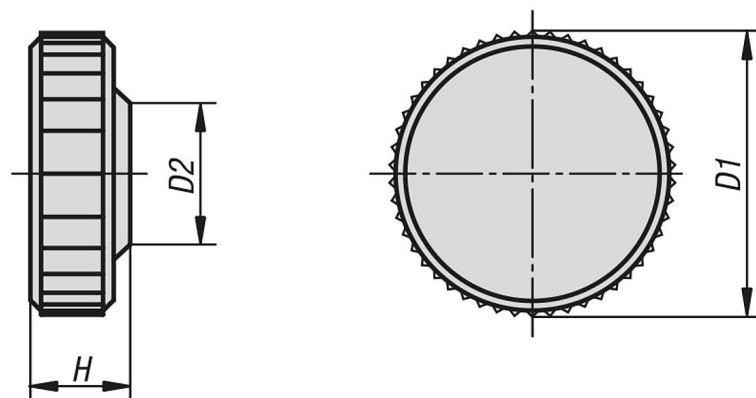

Overview of items

Order No.	Main colour	D1	D2	H	for cap screws
06132-030	black	9,5	8,3	4,5	M3
06132-0305	grey	9,5	8,3	4,5	M3
06132-0306	red	9,5	8,3	4,5	M3
06132-040	black	13	9,6	5	M4
06132-0405	grey	13	9,6	5	M4
06132-0406	red	13	9,6	5	M4
06132-050	black	16	11,5	6,5	M5
06132-0505	grey	16	11,5	6,5	M5
06132-0506	red	16	11,5	6,5	M5
06132-060	black	19	14	7,5	M6
06132-0605	grey	19	14	7,5	M6
06132-0606	red	19	14	7,5	M6
06132-061	black	26	13	8	M6
06132-0615	grey	26	13	8	M6
06132-0616	red	26	13	8	M6
06132-080	black	26	16	10	M8
06132-0805	grey	26	16	10	M8
06132-0806	red	26	16	10	M8