

## Item description/product images



## Description

**Material:**

Grip thermoplastic.  
Steel parts electro zinc-plated.

**Version:**

Black satin finished.

**Note:**

Cylindrical grips can be screwed onto our handwheels, crank handles etc.

## Drawings

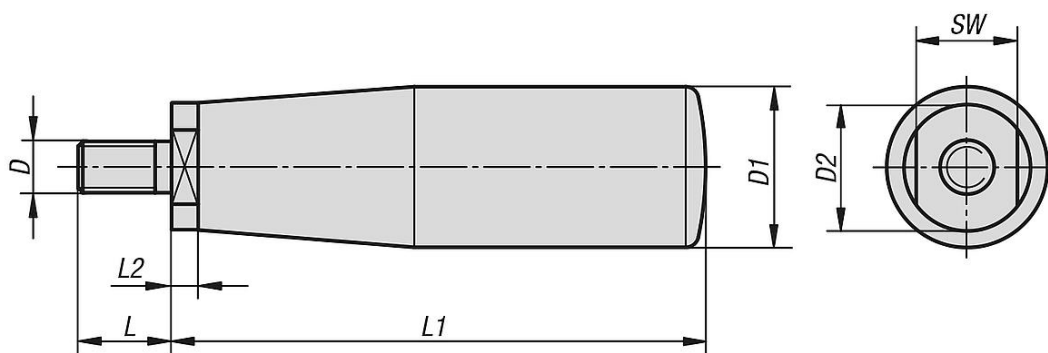

## Overview of items

Order No.	D	D1	D2	L	L1	L2	SW
06322-06200500	M6	20	12	12	55	5	10
06322-08230600	M8	23	14	15	67	7	13
06322-08250690	M8	25	14	15	77	7	13
06322-10250690	M10	25	14	15	77	7	13
06322-10250800	M10	26	18	15	86	7	16
06322-10270890	M10	27	18	15	97	7	16
06322-12250800	M12	26	18	15	86	7	16
06322-12270890	M12	27	18	15	97	7	16