

Item description/product images

**Description****Material:**

Inner ring, outer ring and rolling elements, bearing steel.
Cage, steel.

Version:

open.

Note:

Spherical roller bearings accept high radial and axial loads. Axial loads are absorbed in both directions.

They are designed for high loading. Spherical roller bearings compensate for angular errors (set angle α). With groove and lubrication holes.

The main dimensions of the spherical roller bearing conform to DIN 625-2. Dimensional and running tolerances correspond to tolerance class PN acc. to DIN 620. The radial internal clearance corresponds to the clearance CN acc. to DIN 620-4. These tolerance classes are standard and well suited for most applications.

Temperature range:

-30 °C to +200 °C.

On request:

Other dimensions and versions.

Drawings

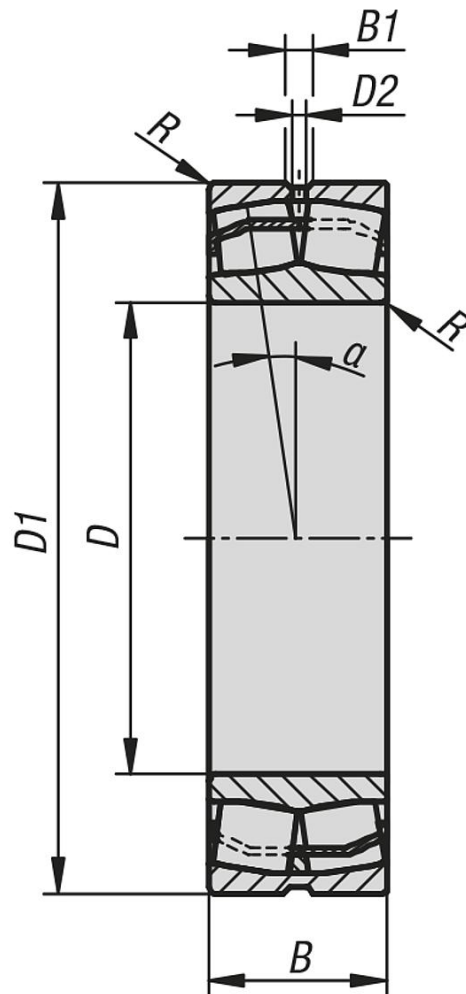

Overview of items

Order No.	Abbreviation	D	D1	D2	B	B1	R min.	α	Dynamic load rating N	Static load rating N	Speed limit rpm
23815-002505218	22205-E1	25	52	3,2	18	4,8	1	1,5°	48000	42500	17000
23815-003006220	22206-E1	30	62	3,2	20	4,8	1	1,5°	64000	57000	13000
23815-003507223	22207-E1	35	72	3,2	23	4,8	1,1	1,5°	88000	81500	11000
23815-004008023	22208-E1	40	80	3,2	23	4,8	1,1	1,5°	101000	91000	10000
23815-004508523	22209-E1	45	85	3,2	23	4,8	1,1	1,5°	104000	99000	10000
23815-005009023	22210-E1	50	90	3,2	23	4,8	1,1	1,5°	109000	107000	9500