

Item description/product images



Description

Material:

Thermoset PF 31.
Steel or stainless steel.

Version:

Thermoset black, high-gloss polished.
Trivalent blue passivated steel or bright stainless steel.

On request:

Other screw lengths.

Drawings

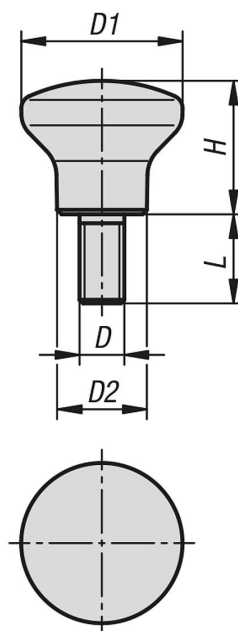

Overview of items

Order No.	Component material	D	D1	D2	H	L
06239-1805X10	steel	M5	18	10	15	10
06239-2106X10	steel	M6	21	12	17	10
06239-2506X10	steel	M6	25	14	21	10
06239-3308X15	steel	M8	33	18	29	15
06239-11805X10	stainless steel	M5	18	10	15	10
06239-12106X10	stainless steel	M6	21	12	17	10
06239-12506X10	stainless steel	M6	25	14	21	10
06239-13308X15	stainless steel	M8	33	18	29	15