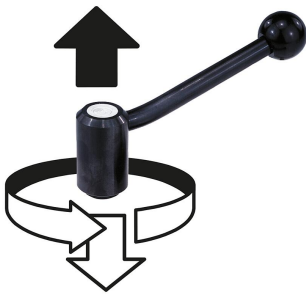

## Item description/product images

INCH  
Partslift to  
disengage**Description****Material:**

Steel parts grade 5.8.  
Ball knob black plastic.

**Version:**

Powder-coated with fine texture, black.

**Note:**

For the inch series, dimension X is in inches, all other dimensions are in mm.

**On request:**

Other threads and special versions.

Dimensions "H1" and "A" available in other lengths at extra charge.

Drawings

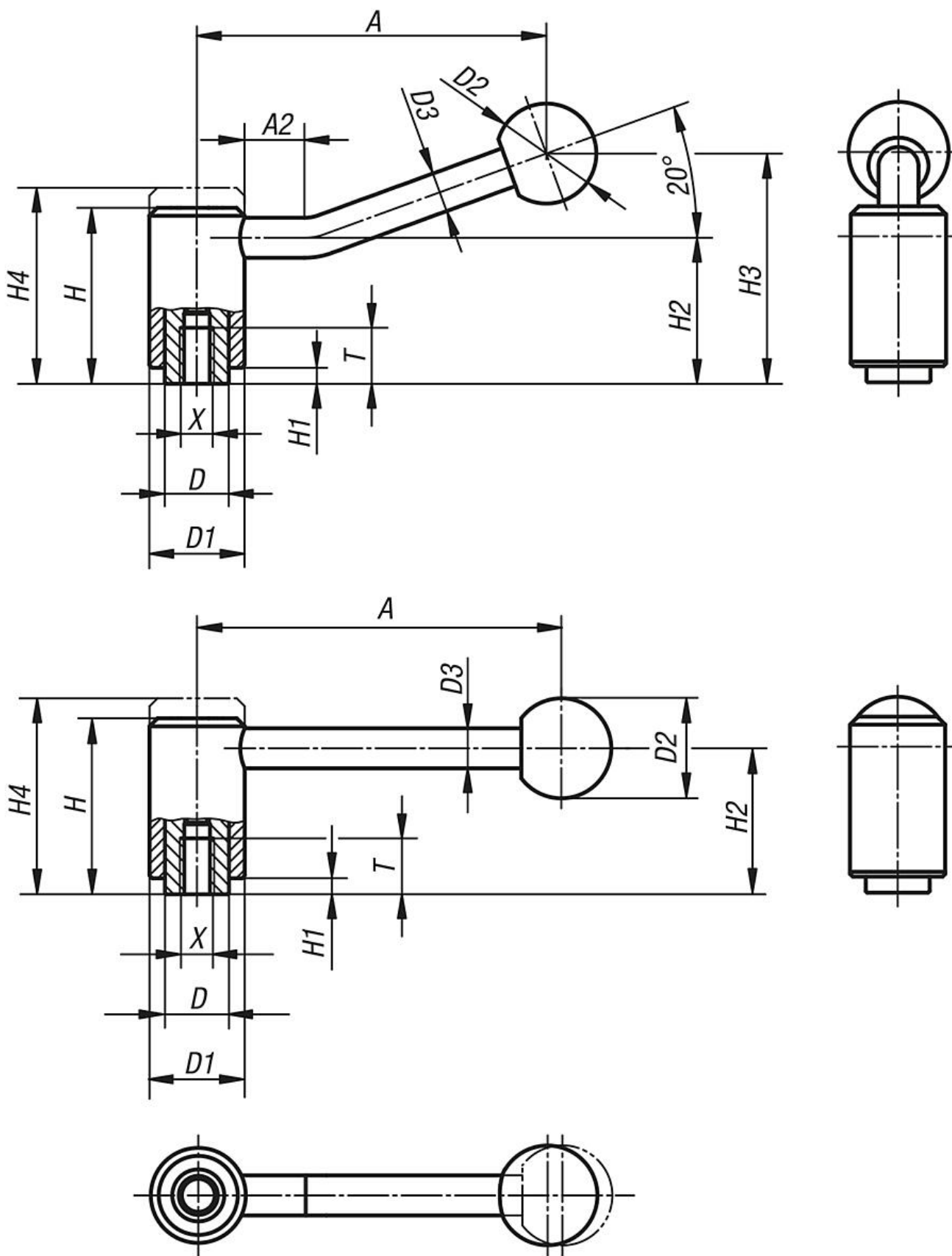

Overview of items

## Overview of items

## Tension Levers, with female thread, inch

Order No.	Form	X	T	A	A2	D	D1	D2	D3	H	H1	H2	H3	H4	No. of teeth
06370-1A32	0°	5/16-18	14	92	-	16	24	25	10	44,5	4,5	37	-	49,5	22
06370-1A42	0°	3/8-16	14	92	-	16	24	25	10	44,5	4,5	37	-	49,5	22
06370-2A42	0°	3/8-16	17	111	-	19	28	32	12	51,5	5,5	42	-	57,5	24
06370-2A52	0°	1/2-13	17	111	-	19	28	32	12	51,5	5,5	42	-	57,5	24
06370-3A52	0°	1/2-13	23	134,5	-	23	33	32	13	58	6	47	-	65	26
06370-3A62	0°	5/8-11	23	134,5	-	23	33	32	13	58	6	47	-	65	26
06370-4A62	0°	5/8-11	27	134	-	30	41	32	13	68,5	7,5	56,5	-	76,5	36
06370-4A72	0°	3/4-10	27	134	-	30	41	32	13	68,5	7,5	56,5	-	76,5	36
06370-1A31	20°	5/16-18	14	88	15	16	24	25	10	44,5	4,5	37	58,5	49,5	22
06370-1A41	20°	3/8-16	14	88	15	16	24	25	10	44,5	4,5	37	58,5	49,5	22
06370-2A41	20°	3/8-16	17	106	15	19	28	32	12	51,5	5,5	42	68,5	57,5	24
06370-2A51	20°	1/2-13	17	106	15	19	28	32	12	51,5	5,5	42	68,5	57,5	24
06370-3A51	20°	1/2-13	23	128,5	15	23	33	32	13	58	6	47	81	65	26
06370-3A61	20°	5/8-11	23	128,5	15	23	33	32	13	58	6	47	81	65	26
06370-4A61	20°	5/8-11	27	128,5	15	30	41	32	13	68,5	7,5	56,5	89,5	76,5	36
06370-4A71	20°	3/4-10	27	128,5	15	30	41	32	13	68,5	7,5	56,5	89,5	76,5	36