

Item description/product images



Description

Material:

Steel, stainless steel A2 or stainless steel A4.

Version:

Steel grade 8.8, bright (black) or electro zinc-plated.

Steel grade 10.9, bright (black) or electro zinc-plated.

Stainless steel A2-70, bright.

Stainless steel A4-70, bright.

Drawings

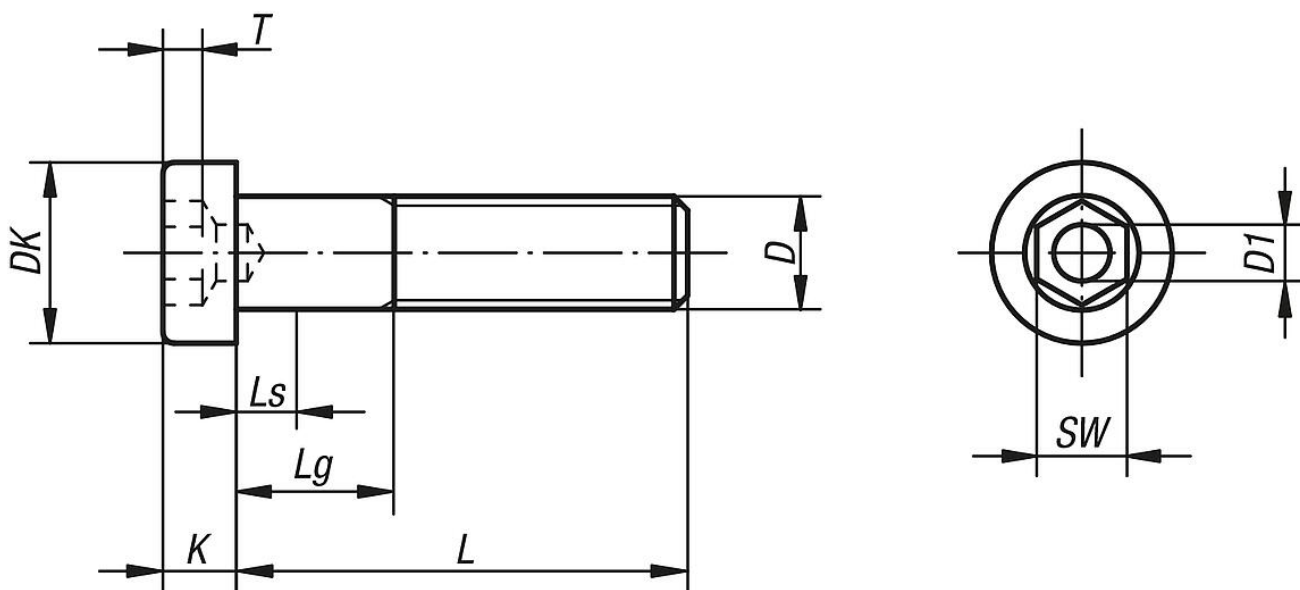

Overview of items

Order No.	Main material	Grade	Surface finish body	D	L	Ls min.	Lg max.	DK	K	D1	SW	T
07161-04X10	steel	8.8	bright (black)	M4	10	1,4	3,5	7	2,8	2	3	1,48
07161-04X12	steel	8.8	bright (black)	M4	12	1,4	3,5	7	2,8	2	3	1,48
07161-04X16	steel	8.8	bright (black)	M4	16	1,4	3,5	7	2,8	2	3	1,48
07161-04X20	steel	8.8	bright (black)	M4	20	2,5	6	7	2,8	2	3	1,48
07161-04X25	steel	8.8	bright (black)	M4	25	7,5	11	7	2,8	2	3	1,48
07161-05X10	steel	8.8	bright (black)	M5	10	1,8	4,2	8,5	3,5	2,5	4	1,88
07161-05X12	steel	8.8	bright (black)	M5	12	1,8	4,2	8,5	3,5	2,5	4	1,88
07161-05X16	steel	8.8	bright (black)	M5	16	1,8	4,2	8,5	3,5	2,5	4	1,88
07161-05X20	steel	8.8	bright (black)	M5	20	1,8	4,2	8,5	3,5	2,5	4	1,88
07161-05X25	steel	8.8	bright (black)	M5	25	5	9	8,5	3,5	2,5	4	1,88
07161-05X30	steel	8.8	bright (black)	M5	30	10	14	8,5	3,5	2,5	4	1,88
07161-06X10	steel	8.8	bright (black)	M6	10	2,5	5,5	10	4	3	5	2,38
07161-06X12	steel	8.8	bright (black)	M6	12	2,5	5,5	10	4	3	5	2,38
07161-06X16	steel	8.8	bright (black)	M6	16	2,5	5,5	10	4	3	5	2,38
07161-06X20	steel	8.8	bright (black)	M6	20	2,5	5,5	10	4	3	5	2,38
07161-06X25	steel	8.8	bright (black)	M6	25	2,5	5,5	10	4	3	5	2,38
07161-06X30	steel	8.8	bright (black)	M6	30	7	12	10	4	3	5	2,38
07161-06X35	steel	8.8	bright (black)	M6	35	12	17	10	4	3	5	2,38
07161-06X40	steel	8.8	bright (black)	M6	40	17	22	10	4	3	5	2,38
07161-06X45	steel	8.8	bright (black)	M6	45	22	27	10	4	3	5	2,38
07161-06X50	steel	8.8	bright (black)	M6	50	27	32	10	4	3	5	2,38
07161-06X60	steel	8.8	bright (black)	M6	60	37	42	10	4	3	5	2,38

Overview of items

Order No.	Main material	Grade	Surface finish body	D	L	LS min.	Lg max.	DK	K	D1	SW	T
07161-08X10	steel	8.8	bright (black)	M8	10	0	6,25	13	5	4	6	2,88
07161-08X12	steel	8.8	bright (black)	M8	12	3,2	7	13	5	4	6	2,88
07161-08X16	steel	8.8	bright (black)	M8	16	3,2	7	13	5	4	6	2,88
07161-08X20	steel	8.8	bright (black)	M8	20	3,2	7	13	5	4	6	2,88
07161-08X25	steel	8.8	bright (black)	M8	25	3,2	7	13	5	4	6	2,88
07161-08X30	steel	8.8	bright (black)	M8	30	3,2	7	13	5	4	6	2,88
07161-08X35	steel	8.8	bright (black)	M8	35	6,75	13	13	5	4	6	2,88
07161-08X40	steel	8.8	bright (black)	M8	40	11,75	18	13	5	4	6	2,88
07161-08X45	steel	8.8	bright (black)	M8	45	16,75	23	13	5	4	6	2,88
07161-08X50	steel	8.8	bright (black)	M8	50	21,75	28	13	5	4	6	2,88
07161-08X60	steel	8.8	bright (black)	M8	60	31,75	38	13	5	4	6	2,88
07161-08X70	steel	8.8	bright (black)	M8	70	41,75	48	13	5	4	6	2,88
07161-08X80	steel	8.8	bright (black)	M8	80	51,75	58	13	5	4	6	2,88
07161-10X16	steel	8.8	bright (black)	M10	16	3,5	8	16	6,5	5	8	3,35
07161-10X20	steel	8.8	bright (black)	M10	20	3,5	8	16	6,5	5	8	3,35
07161-10X25	steel	8.8	bright (black)	M10	25	3,5	8	16	6,5	5	8	3,35
07161-10X30	steel	8.8	bright (black)	M10	30	3,5	8	16	6,5	5	8	3,35
07161-10X35	steel	8.8	bright (black)	M10	35	3,5	8	16	6,5	5	8	3,35
07161-10X40	steel	8.8	bright (black)	M10	40	6,5	14	16	6,5	5	8	3,35
07161-10X45	steel	8.8	bright (black)	M10	45	11,5	19	16	6,5	5	8	3,35
07161-10X50	steel	8.8	bright (black)	M10	50	16,5	24	16	6,5	5	8	3,35
07161-10X60	steel	8.8	bright (black)	M10	60	26,5	34	16	6,5	5	8	3,35
07161-10X70	steel	8.8	bright (black)	M10	70	36,5	44	16	6,5	5	8	3,35
07161-10X80	steel	8.8	bright (black)	M10	80	46,5	54	16	6,5	5	8	3,35
07161-10X90	steel	8.8	bright (black)	M10	90	56,5	64	16	6,5	5	8	3,35
07161-10X100	steel	8.8	bright (black)	M10	100	66,5	65	16	6,5	5	8	3,35
07161-12X20	steel	8.8	bright (black)	M12	20	4,2	9,5	18	7,5	6	10	3,85
07161-12X25	steel	8.8	bright (black)	M12	25	4,2	9,5	18	7,5	6	10	3,85
07161-12X30	steel	8.8	bright (black)	M12	30	4,2	9,5	18	7,5	6	10	3,85
07161-12X35	steel	8.8	bright (black)	M12	35	4,2	9,5	18	7,5	6	10	3,85
07161-12X40	steel	8.8	bright (black)	M12	40	4,2	9,5	18	7,5	6	10	3,85
07161-12X45	steel	8.8	bright (black)	M12	45	6,5	15	18	7,5	6	10	3,85
07161-12X50	steel	8.8	bright (black)	M12	50	11,5	20	18	7,5	6	10	3,85
07161-12X60	steel	8.8	bright (black)	M12	60	21,5	30	18	7,5	6	10	3,85
07161-12X70	steel	8.8	bright (black)	M12	70	31,5	40	18	7,5	6	10	3,85
07161-12X80	steel	8.8	bright (black)	M12	80	41,5	50	18	7,5	6	10	3,85
07161-12X90	steel	8.8	bright (black)	M12	90	51,5	60	18	7,5	6	10	3,85
07161-12X100	steel	8.8	bright (black)	M12	100	61,5	70	18	7,5	6	10	3,85
07161-12X110	steel	8.8	bright (black)	M12	110	71,5	80	18	7,5	6	10	3,85
07161-12X120	steel	8.8	bright (black)	M12	120	81,5	90	18	7,5	6	10	3,85
07161-16X30	steel	8.8	bright (black)	M16	30	5	11	24	10	8	14	5,35
07161-16X35	steel	8.8	bright (black)	M16	35	5	11	24	10	8	14	5,35
07161-16X40	steel	8.8	bright (black)	M16	40	5	11	24	10	8	14	5,35
07161-16X45	steel	8.8	bright (black)	M16	45	5	11	24	10	8	14	5,35
07161-16X50	steel	8.8	bright (black)	M16	50	5	11	24	10	8	14	5,35
07161-16X60	steel	8.8	bright (black)	M16	60	12	22	24	10	8	14	5,35
07161-16X70	steel	8.8	bright (black)	M16	70	22	32	24	10	8	14	5,35
07161-16X80	steel	8.8	bright (black)	M16	80	32	42	24	10	8	14	5,35
07161-16X90	steel	8.8	bright (black)	M16	90	42	52	24	10	8	14	5,35
07161-16X100	steel	8.8	bright (black)	M16	100	52	62	24	10	8	14	5,35
07161-16X110	steel	8.8	bright (black)	M16	110	62	72	24	10	8	14	5,35
07161-16X120	steel	8.8	bright (black)	M16	120	72	82	24	10	8	14	5,35
07161-20X40	steel	8.8	bright (black)	M20	40	6,5	14	30	12	10	17	6,32
07161-20X45	steel	8.8	bright (black)	M20	45	6,5	14	30	12	10	17	6,32
07161-20X50	steel	8.8	bright (black)	M20	50	6,5	14	30	12	10	17	6,32
07161-20X60	steel	8.8	bright (black)	M20	60	6,5	14	30	12	10	17	6,32
07161-20X70	steel	8.8	bright (black)	M20	70	11,5	24	30	12	10	17	6,32
07161-20X80	steel	8.8	bright (black)	M20	80	21,5	34	30	12	10	17	6,32
07161-20X90	steel	8.8	bright (black)	M20	90	31,5	44	30	12	10	17	6,32
07161-20X100	steel	8.8	bright (black)	M20	100	41,5	54	30	12	10	17	6,32
07161-20X110	steel	8.8	bright (black)	M20	110	51,5	64	30	12	10	17	6,32
07161-20X120	steel	8.8	bright (black)	M20	120	61,5	74	30	12	10	17	6,32
07161-404X10	steel	8.8	galvanised	M4	10	1,4	3,5	7	2,8	2	3	1,48
07161-404X12	steel	8.8	galvanised	M4	12	1,4	3,5	7	2,8	2	3	1,48
07161-404X16	steel	8.8	galvanised	M4	16	1,4	3,5	7	2,8	2	3	1,48

Overview of items

Order No.	Main material	Grade	Surface finish body	D	L	LS min.	Lg max.	DK	K	D1	SW	T
07161-404X20	steel	8.8	galvanised	M4	20	2,5	6	7	2,8	2	3	1,48
07161-404X25	steel	8.8	galvanised	M4	25	7,5	11	7	2,8	2	3	1,48
07161-405X10	steel	8.8	galvanised	M5	10	1,8	4,2	8,5	3,5	2,5	4	1,88
07161-405X12	steel	8.8	galvanised	M5	12	1,8	4,2	8,5	3,5	2,5	4	1,88
07161-405X16	steel	8.8	galvanised	M5	16	1,8	4,2	8,5	3,5	2,5	4	1,88
07161-405X20	steel	8.8	galvanised	M5	20	1,8	4,2	8,5	3,5	2,5	4	1,88
07161-405X25	steel	8.8	galvanised	M5	25	5	9	8,5	3,5	2,5	4	1,88
07161-405X30	steel	8.8	galvanised	M5	30	10	14	8,5	3,5	2,5	4	1,88
07161-406X10	steel	8.8	galvanised	M6	10	2,5	5,5	10	4	3	5	2,38
07161-406X12	steel	8.8	galvanised	M6	12	2,5	5,5	10	4	3	5	2,38
07161-406X16	steel	8.8	galvanised	M6	16	2,5	5,5	10	4	3	5	2,38
07161-406X20	steel	8.8	galvanised	M6	20	2,5	5,5	10	4	3	5	2,38
07161-406X25	steel	8.8	galvanised	M6	25	2,5	5,5	10	4	3	5	2,38
07161-406X30	steel	8.8	galvanised	M6	30	7	12	10	4	3	5	2,38
07161-406X35	steel	8.8	galvanised	M6	35	12	17	10	4	3	5	2,38
07161-406X40	steel	8.8	galvanised	M6	40	17	22	10	4	3	5	2,38
07161-406X45	steel	8.8	galvanised	M6	45	22	27	10	4	3	5	2,38
07161-406X50	steel	8.8	galvanised	M6	50	27	32	10	4	3	5	2,38
07161-406X60	steel	8.8	galvanised	M6	60	37	42	10	4	3	5	2,38
07161-408X10	steel	8.8	galvanised	M8	10	0	6,25	13	5	4	6	2,88
07161-408X12	steel	8.8	galvanised	M8	12	3,2	7	13	5	4	6	2,88
07161-408X16	steel	8.8	galvanised	M8	16	3,2	7	13	5	4	6	2,88
07161-408X20	steel	8.8	galvanised	M8	20	3,2	7	13	5	4	6	2,88
07161-408X25	steel	8.8	galvanised	M8	25	3,2	7	13	5	4	6	2,88
07161-408X30	steel	8.8	galvanised	M8	30	3,2	7	13	5	4	6	2,88
07161-408X35	steel	8.8	galvanised	M8	35	6,75	13	13	5	4	6	2,88
07161-408X40	steel	8.8	galvanised	M8	40	11,75	18	13	5	4	6	2,88
07161-408X45	steel	8.8	galvanised	M8	45	16,75	23	13	5	4	6	2,88
07161-408X50	steel	8.8	galvanised	M8	50	21,75	28	13	5	4	6	2,88
07161-408X60	steel	8.8	galvanised	M8	60	31,75	38	13	5	4	6	2,88
07161-408X70	steel	8.8	galvanised	M8	70	41,75	48	13	5	4	6	2,88
07161-408X80	steel	8.8	galvanised	M8	80	51,75	58	13	5	4	6	2,88
07161-410X20	steel	8.8	galvanised	M10	20	3,5	8	16	6,5	5	8	3,35
07161-410X25	steel	8.8	galvanised	M10	25	3,5	8	16	6,5	5	8	3,35
07161-410X30	steel	8.8	galvanised	M10	30	3,5	8	16	6,5	5	8	3,35
07161-410X35	steel	8.8	galvanised	M10	35	3,5	8	16	6,5	5	8	3,35
07161-410X40	steel	8.8	galvanised	M10	40	6,5	14	16	6,5	5	8	3,35
07161-410X45	steel	8.8	galvanised	M10	45	11,5	19	16	6,5	5	8	3,35
07161-410X50	steel	8.8	galvanised	M10	50	16,5	24	16	6,5	5	8	3,35
07161-410X60	steel	8.8	galvanised	M10	60	26,5	34	16	6,5	5	8	3,35
07161-410X70	steel	8.8	galvanised	M10	70	36,5	44	16	6,5	5	8	3,35
07161-410X80	steel	8.8	galvanised	M10	80	46,5	54	16	6,5	5	8	3,35
07161-410X90	steel	8.8	galvanised	M10	90	56,5	64	16	6,5	5	8	3,35
07161-410X100	steel	8.8	galvanised	M10	100	66,5	74	16	6,5	5	8	3,35
07161-412X20	steel	8.8	galvanised	M12	20	4,2	9,5	18	7,5	6	10	3,85
07161-412X25	steel	8.8	galvanised	M12	25	4,2	9,5	18	7,5	6	10	3,85
07161-412X30	steel	8.8	galvanised	M12	30	4,2	9,5	18	7,5	6	10	3,85
07161-412X35	steel	8.8	galvanised	M12	35	4,2	9,5	18	7,5	6	10	3,85
07161-412X40	steel	8.8	galvanised	M12	40	4,2	9,5	18	7,5	6	10	3,85
07161-412X45	steel	8.8	galvanised	M12	45	6,5	15	18	7,5	6	10	3,85
07161-412X50	steel	8.8	galvanised	M12	50	11,5	20	18	7,5	6	10	3,85
07161-412X60	steel	8.8	galvanised	M12	60	21,5	30	18	7,5	6	10	3,85
07161-412X70	steel	8.8	galvanised	M12	70	31,5	40	18	7,5	6	10	3,85
07161-412X80	steel	8.8	galvanised	M12	80	41,5	50	18	7,5	6	10	3,85
07161-412X90	steel	8.8	galvanised	M12	90	51,5	60	18	7,5	6	10	3,85
07161-412X100	steel	8.8	galvanised	M12	100	61,5	70	18	7,5	6	10	3,85
07161-412X110	steel	8.8	galvanised	M12	110	71,5	80	18	7,5	6	10	3,85
07161-412X120	steel	8.8	galvanised	M12	120	81,5	90	18	7,5	6	10	3,85
07161-416X30	steel	8.8	galvanised	M16	30	5	11	24	10	8	14	5,35
07161-416X35	steel	8.8	galvanised	M16	35	5	11	24	10	8	14	5,35
07161-416X40	steel	8.8	galvanised	M16	40	5	11	24	10	8	14	5,35
07161-416X45	steel	8.8	galvanised	M16	45	5	11	24	10	8	14	5,35
07161-416X50	steel	8.8	galvanised	M16	50	5	11	24	10	8	14	5,35
07161-416X60	steel	8.8	galvanised	M16	60	12	22	24	10	8	14	5,35
07161-416X70	steel	8.8	galvanised	M16	70	22	32	24	10	8	14	5,35

Overview of items

Order No.	Main material	Grade	Surface finish body	D	L	Ls min.	Lg max.	DK	K	D1	SW	T
07161-416X80	steel	8.8	galvanised	M16	80	32	42	24	10	8	14	5,35
07161-416X90	steel	8.8	galvanised	M16	90	42	52	24	10	8	14	5,35
07161-416X100	steel	8.8	galvanised	M16	100	52	62	24	10	8	14	5,35
07161-416X110	steel	8.8	galvanised	M16	110	62	72	24	10	8	14	5,35
07161-416X120	steel	8.8	galvanised	M16	120	72	82	24	10	8	14	5,35
07161-420X40	steel	8.8	galvanised	M20	40	6,5	14	30	12	10	17	6,32
07161-420X45	steel	8.8	galvanised	M20	45	6,5	14	30	12	10	17	6,32
07161-420X50	steel	8.8	galvanised	M20	50	6,5	14	30	12	10	17	6,32
07161-420X60	steel	8.8	galvanised	M20	60	6,5	14	30	12	10	17	6,32
07161-420X70	steel	8.8	galvanised	M20	70	11,5	24	30	12	10	17	6,32
07161-420X80	steel	8.8	galvanised	M20	80	21,5	34	30	12	10	17	6,32
07161-420X90	steel	8.8	galvanised	M20	90	31,5	44	30	12	10	17	6,32
07161-420X100	steel	8.8	galvanised	M20	100	41,5	54	30	12	10	17	6,32
07161-420X110	steel	8.8	galvanised	M20	110	51,5	64	30	12	10	17	6,32
07161-420X120	steel	8.8	galvanised	M20	120	61,5	74	30	12	10	17	6,32
07161-306X10	steel	10.9	bright (black)	M6	10	2,5	5,5	10	4	3	5	2,38
07161-306X12	steel	10.9	bright (black)	M6	12	2,5	5,5	10	4	3	5	2,38
07161-306X16	steel	10.9	bright (black)	M6	16	2,5	5,5	10	4	3	5	2,38
07161-306X20	steel	10.9	bright (black)	M6	20	2,5	5,5	10	4	3	5	2,38
07161-306X25	steel	10.9	bright (black)	M6	25	2,5	5,5	10	4	3	5	2,38
07161-306X30	steel	10.9	bright (black)	M6	30	7	12	10	4	3	5	2,38
07161-306X35	steel	10.9	bright (black)	M6	35	12	17	10	4	3	5	2,38
07161-306X40	steel	10.9	bright (black)	M6	40	17	22	10	4	3	5	2,38
07161-308X16	steel	10.9	bright (black)	M8	16	3,2	7	13	5	4	6	2,88
07161-308X20	steel	10.9	bright (black)	M8	20	3,2	7	13	5	4	6	2,88
07161-308X25	steel	10.9	bright (black)	M8	25	3,2	7	13	5	4	6	2,88
07161-308X30	steel	10.9	bright (black)	M8	30	3,2	7	13	5	4	6	2,88
07161-308X35	steel	10.9	bright (black)	M8	35	6,75	13	13	5	4	6	2,88
07161-308X40	steel	10.9	bright (black)	M8	40	11,75	18	13	5	4	6	2,88
07161-308X45	steel	10.9	bright (black)	M8	45	16,75	23	13	5	4	6	2,88
07161-308X50	steel	10.9	bright (black)	M8	50	21,75	28	13	5	4	6	2,88
07161-308X60	steel	10.9	bright (black)	M8	60	31,75	38	13	5	4	6	2,88
07161-310X20	steel	10.9	bright (black)	M10	20	3,5	8	16	6,5	5	8	3,35
07161-310X25	steel	10.9	bright (black)	M10	25	3,5	8	16	6,5	5	8	3,35
07161-310X30	steel	10.9	bright (black)	M10	30	3,5	8	16	6,5	5	8	3,35
07161-310X35	steel	10.9	bright (black)	M10	35	3,5	8	16	6,5	5	8	3,35
07161-310X40	steel	10.9	bright (black)	M10	40	6,5	14	16	6,5	5	8	3,35
07161-310X45	steel	10.9	bright (black)	M10	45	11,5	19	16	6,5	5	8	3,35
07161-310X50	steel	10.9	bright (black)	M10	50	16,5	24	16	6,5	5	8	3,35
07161-310X60	steel	10.9	bright (black)	M10	60	26,5	34	16	6,5	5	8	3,35
07161-312X25	steel	10.9	bright (black)	M12	25	4,2	9,5	18	7,5	6	10	3,85
07161-312X30	steel	10.9	bright (black)	M12	30	4,2	9,5	18	7,5	6	10	3,85
07161-312X35	steel	10.9	bright (black)	M12	35	4,2	9,5	18	7,5	6	10	3,85
07161-312X40	steel	10.9	bright (black)	M12	40	4,2	9,5	18	7,5	6	10	3,85
07161-312X45	steel	10.9	bright (black)	M12	45	6,5	15	18	7,5	6	10	3,85
07161-312X50	steel	10.9	bright (black)	M12	50	11,5	20	18	7,5	6	10	3,85
07161-312X60	steel	10.9	bright (black)	M12	60	21,5	30	18	7,5	6	10	3,85
07161-316X30	steel	10.9	bright (black)	M16	30	5	11	24	10	8	14	5,35
07161-316X35	steel	10.9	bright (black)	M16	35	5	11	24	10	8	14	5,35
07161-316X40	steel	10.9	bright (black)	M16	40	5	11	24	10	8	14	5,35
07161-316X45	steel	10.9	bright (black)	M16	45	5	11	24	10	8	14	5,35
07161-316X50	steel	10.9	bright (black)	M16	50	5	11	24	10	8	14	5,35
07161-316X60	steel	10.9	bright (black)	M16	60	12	22	24	10	8	14	5,35
07161-316X70	steel	10.9	bright (black)	M16	70	22	32	24	10	8	14	5,35
07161-316X80	steel	10.9	bright (black)	M16	80	32	42	24	10	8	14	5,35
07161-320X40	steel	10.9	bright (black)	M20	40	6,5	14	30	12	10	17	6,32
07161-320X50	steel	10.9	bright (black)	M20	50	6,5	14	30	12	10	17	6,32
07161-320X60	steel	10.9	bright (black)	M20	60	6,5	14	30	12	10	17	6,32
07161-320X70	steel	10.9	bright (black)	M20	70	11,5	24	30	12	10	17	6,32
07161-104X10	stainless steel A2	70	bright	M4	10	1,4	3,5	7	2,8	2	3	1,48
07161-104X12	stainless steel A2	70	bright	M4	12	1,4	3,5	7	2,8	2	3	1,48
07161-104X16	stainless steel A2	70	bright	M4	16	1,4	3,5	7	2,8	2	3	1,48
07161-104X20	stainless steel A2	70	bright	M4	20	2,5	6	7	2,8	2	3	1,48
07161-104X25	stainless steel A2	70	bright	M4	25	4,5	11	7	2,8	2	3	1,48
07161-105X10	stainless steel A2	70	bright	M5	10	1,8	4,2	8,5	3,5	2,5	4	1,88

Overview of items

Order No.	Main material	Grade	Surface finish body	D	L	LS min.	Lg max.	DK	K	D1	SW	T
07161-105X12	stainless steel A2	70	bright	M5	12	1,8	4,2	8,5	3,5	2,5	4	1,88
07161-105X16	stainless steel A2	70	bright	M5	16	1,8	4,2	8,5	3,5	2,5	4	1,88
07161-105X20	stainless steel A2	70	bright	M5	20	1,8	4,2	8,5	3,5	2,5	4	1,88
07161-105X25	stainless steel A2	70	bright	M5	25	5	9	8,5	3,5	2,5	4	1,88
07161-105X30	stainless steel A2	70	bright	M5	30	10	14	8,5	3,5	2,5	4	1,88
07161-106X10	stainless steel A2	70	bright	M6	10	2,5	5,5	10	4	3	5	2,38
07161-106X12	stainless steel A2	70	bright	M6	12	2,5	5,5	10	4	3	5	2,38
07161-106X16	stainless steel A2	70	bright	M6	16	2,5	5,5	10	4	3	5	2,38
07161-106X20	stainless steel A2	70	bright	M6	20	2,5	5,5	10	4	3	5	2,38
07161-106X25	stainless steel A2	70	bright	M6	25	2,5	5,5	10	4	3	5	2,38
07161-106X30	stainless steel A2	70	bright	M6	30	7	12	10	4	3	5	2,38
07161-106X35	stainless steel A2	70	bright	M6	35	12	17	10	4	3	5	2,38
07161-106X40	stainless steel A2	70	bright	M6	40	17	22	10	4	3	5	2,38
07161-106X45	stainless steel A2	70	bright	M6	45	22	27	10	4	3	5	2,38
07161-106X50	stainless steel A2	70	bright	M6	50	27	32	10	4	3	5	2,38
07161-106X60	stainless steel A2	70	bright	M6	60	37	42	10	4	3	5	2,38
07161-108X10	stainless steel A2	70	bright	M8	10	0	6,25	13	5	4	6	2,88
07161-108X12	stainless steel A2	70	bright	M8	12	3,2	7	13	5	4	6	2,88
07161-108X16	stainless steel A2	70	bright	M8	16	3,2	7	13	5	4	6	2,88
07161-108X20	stainless steel A2	70	bright	M8	20	3,2	7	13	5	4	6	2,88
07161-108X25	stainless steel A2	70	bright	M8	25	3,2	7	13	5	4	6	2,88
07161-108X30	stainless steel A2	70	bright	M8	30	3,2	7	13	5	4	6	2,88
07161-108X35	stainless steel A2	70	bright	M8	35	6,75	13	13	5	4	6	2,88
07161-108X40	stainless steel A2	70	bright	M8	40	11,75	18	13	5	4	6	2,88
07161-108X45	stainless steel A2	70	bright	M8	45	16,75	23	13	5	4	6	2,88
07161-108X50	stainless steel A2	70	bright	M8	50	21,75	28	13	5	4	6	2,88
07161-108X60	stainless steel A2	70	bright	M8	60	31,75	38	13	5	4	6	2,88
07161-108X70	stainless steel A2	70	bright	M8	70	41,75	48	13	5	4	6	2,88
07161-110X16	stainless steel A2	70	bright	M10	16	3,5	8	16	6,5	5	8	3,35
07161-110X20	stainless steel A2	70	bright	M10	20	3,5	8	16	6,5	5	8	3,35
07161-110X25	stainless steel A2	70	bright	M10	25	3,5	8	16	6,5	5	8	3,35
07161-110X30	stainless steel A2	70	bright	M10	30	3,5	8	16	6,5	5	8	3,35
07161-110X35	stainless steel A2	70	bright	M10	35	3,5	8	16	6,5	5	8	3,35
07161-110X40	stainless steel A2	70	bright	M10	40	6,5	14	16	6,5	5	8	3,35
07161-110X45	stainless steel A2	70	bright	M10	45	11,5	19	16	6,5	5	8	3,35
07161-110X50	stainless steel A2	70	bright	M10	50	16,5	24	16	6,5	5	8	3,35
07161-110X60	stainless steel A2	70	bright	M10	60	26,5	34	16	6,5	5	8	3,35
07161-110X70	stainless steel A2	70	bright	M10	70	36,5	44	16	6,5	5	8	3,35
07161-112X20	stainless steel A2	70	bright	M12	20	4,2	9,5	18	7,5	6	10	3,85
07161-112X25	stainless steel A2	70	bright	M12	25	4,2	9,5	18	7,5	6	10	3,85
07161-112X30	stainless steel A2	70	bright	M12	30	4,2	9,5	18	7,5	6	10	3,85
07161-112X35	stainless steel A2	70	bright	M12	35	4,2	9,5	18	7,5	6	10	3,85
07161-112X40	stainless steel A2	70	bright	M12	40	4,2	9,5	18	7,5	6	10	3,85
07161-112X45	stainless steel A2	70	bright	M12	45	6,5	15	18	7,5	6	10	3,85
07161-112X50	stainless steel A2	70	bright	M12	50	11,5	20	18	7,5	6	10	3,85
07161-112X60	stainless steel A2	70	bright	M12	60	21,5	30	18	7,5	6	10	3,85
07161-112X70	stainless steel A2	70	bright	M12	70	31,5	40	18	7,5	6	10	3,85
07161-604X10	stainless steel A4	70	bright	M4	10	1,4	3,5	7	2,8	2	3	1,48
07161-604X12	stainless steel A4	70	bright	M4	12	1,4	3,5	7	2,8	2	3	1,48
07161-604X16	stainless steel A4	70	bright	M4	16	1,4	3,5	7	2,8	2	3	1,48
07161-604X20	stainless steel A4	70	bright	M4	20	2,5	6	7	2,8	2	3	1,48
07161-604X25	stainless steel A4	70	bright	M4	25	7,5	11	7	2,8	2	3	1,48
07161-605X10	stainless steel A4	70	bright	M5	10	1,8	4,2	8,5	3,5	2,5	4	1,88
07161-605X12	stainless steel A4	70	bright	M5	12	1,8	4,2	8,5	3,5	2,5	4	1,88
07161-605X16	stainless steel A4	70	bright	M5	16	1,8	4,2	8,5	3,5	2,5	4	1,88
07161-605X20	stainless steel A4	70	bright	M5	20	1,8	4,2	8,5	3,5	2,5	4	1,88
07161-605X25	stainless steel A4	70	bright	M5	25	5	9	8,5	3,5	2,5	4	1,88
07161-605X30	stainless steel A4	70	bright	M5	30	10	14	8,5	3,5	2,5	4	1,88
07161-606X10	stainless steel A4	70	bright	M6	10	2,5	5,5	10	4	3	5	2,38
07161-606X12	stainless steel A4	70	bright	M6	12	2,5	5,5	10	4	3	5	2,38
07161-606X16	stainless steel A4	70	bright	M6	16	2,5	5,5	10	4	3	5	2,38
07161-606X20	stainless steel A4	70	bright	M6	20	2,5	5,5	10	4	3	5	2,38
07161-606X25	stainless steel A4	70	bright	M6	25	2,5	5,5	10	4	3	5	2,38
07161-606X30	stainless steel A4	70	bright	M6	30	7	12	10	4	3	5	2,38
07161-606X35	stainless steel A4	70	bright	M6	35	12	17	10	4	3	5	2,38

Overview of items

Order No.	Main material	Grade	Surface finish body	D	L	LS min.	Lg max.	DK	K	D1	SW	T
07161-606X40	stainless steel A4	70	bright	M6	40	17	22	10	4	3	5	2,38
07161-606X45	stainless steel A4	70	bright	M6	45	22	27	10	4	3	5	2,38
07161-606X50	stainless steel A4	70	bright	M6	50	27	32	10	4	3	5	2,38
07161-606X60	stainless steel A4	70	bright	M6	60	37	42	10	4	3	5	2,38
07161-608X10	stainless steel A4	70	bright	M8	10	0	6,25	13	5	4	6	2,88
07161-608X12	stainless steel A4	70	bright	M8	12	3,2	7	13	5	4	6	2,88
07161-608X16	stainless steel A4	70	bright	M8	16	3,2	7	13	5	4	6	2,88
07161-608X20	stainless steel A4	70	bright	M8	20	3,2	7	13	5	4	6	2,88
07161-608X25	stainless steel A4	70	bright	M8	25	3,2	7	13	5	4	6	2,88
07161-608X30	stainless steel A4	70	bright	M8	30	3,2	7	13	5	4	6	2,88
07161-608X35	stainless steel A4	70	bright	M8	35	6,75	13	13	5	4	6	2,88
07161-608X40	stainless steel A4	70	bright	M8	40	11,75	18	13	5	4	6	2,88
07161-608X45	stainless steel A4	70	bright	M8	45	16,75	23	13	5	4	6	2,88
07161-608X50	stainless steel A4	70	bright	M8	50	21,75	28	13	5	4	6	2,88
07161-608X60	stainless steel A4	70	bright	M8	60	31,75	38	13	5	4	6	2,88
07161-608X70	stainless steel A4	70	bright	M8	70	41,75	48	13	5	4	6	2,88
07161-610X16	stainless steel A4	70	bright	M10	16	3,5	8	16	6,5	5	8	3,35
07161-610X20	stainless steel A4	70	bright	M10	20	3,5	8	16	6,5	5	8	3,35
07161-610X25	stainless steel A4	70	bright	M10	25	3,5	8	16	6,5	5	8	3,35
07161-610X30	stainless steel A4	70	bright	M10	30	3,5	8	16	6,5	5	8	3,35
07161-610X35	stainless steel A4	70	bright	M10	35	3,5	8	16	6,5	5	8	3,35
07161-610X40	stainless steel A4	70	bright	M10	40	6,5	14	16	6,5	5	8	3,35
07161-610X45	stainless steel A4	70	bright	M10	45	11,5	19	16	6,5	5	8	3,35
07161-610X50	stainless steel A4	70	bright	M10	50	16,5	24	16	6,5	5	8	3,35
07161-610X60	stainless steel A4	70	bright	M10	60	26,5	34	16	6,5	5	8	3,35
07161-610X70	stainless steel A4	70	bright	M10	70	36,5	44	16	6,5	5	8	3,35
07161-612X20	stainless steel A4	70	bright	M12	20	4,2	9,5	18	7,5	6	10	3,85
07161-612X25	stainless steel A4	70	bright	M12	25	4,2	9,5	18	7,5	6	10	3,85
07161-612X30	stainless steel A4	70	bright	M12	30	4,2	9,5	18	7,5	6	10	3,85
07161-612X35	stainless steel A4	70	bright	M12	35	4,2	9,5	18	7,5	6	10	3,85
07161-612X40	stainless steel A4	70	bright	M12	40	4,2	9,5	18	7,5	6	10	3,85
07161-612X45	stainless steel A4	70	bright	M12	45	6,5	15	18	7,5	6	10	3,85
07161-612X50	stainless steel A4	70	bright	M12	50	11,5	20	18	7,5	6	10	3,85
07161-612X70	stainless steel A4	70	bright	M12	70	31,5	40	18	7,5	6	10	3,85