

## Item description/product images

**Description****Material:**

Polyester.

**Version:**

Single sleeve.

**Note:**

The round slings comply with DIN EN 1492-2. They are made of high-strength endless polyester fibre cords. These polyester fibre cords are protected by a sturdy and seamlessly woven polyester sleeve. This sleeve surface is also impregnated with polyurethane to make it abrasion-proof. The working load limit (WLL) and the cord tonnage (tonne capacity per cord) are either woven into or printed on the protective sleeve of the sling. The safety label with the CE mark and technical data is firmly sewn onto the sling.

The colour of the round sling corresponds to the colour code scheme for load capacities of textile type slings.

These round slings have high UV resistance and low moisture absorption.

Safety factor 7:1

Example: WLL 1000kg = break load 7000kg.

These round slings carry the CE mark according to the European machinery directive.

**Temperature range:**

-40 °C to +100 °C.

Item description/product images



Drawings

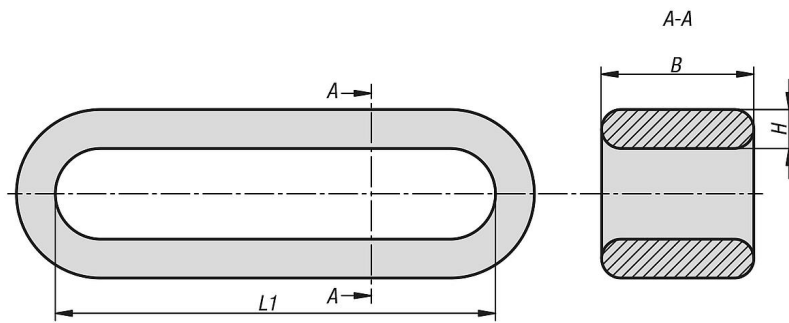

Drawings

		Working load limit (WLL) (t) with round slings							Working load limit (WLL) (t) with 2 round slings			
Sling configuration												
Type		simple direct	simple laced	parallel	*Sling angle $\beta$ over 7-45°		*Sling angle $\beta$ over 45-60°		direct *Sling angle $\beta$ over 7-45°		laced *Sling angle $\beta$ over 7-45°	
**load hoisting factor	Colour	1,0	0,8	2,0	1,4	1,0	0,7	0,5	1,4	1,0	1,12	0,8
1 t	violet	1 t	0,8 t	2 t	1,4 t	1 t	0,7 t	0,5 t	1,4 t	1 t	1,12 t	0,8 t
2 t	green	2 t	1,6 t	4 t	2,8 t	2 t	1,4 t	1,0 t	2,8 t	2 t	2,24 t	1,6 t
3 t	yellow	3 t	2,4 t	6 t	4,2 t	3 t	2,1 t	1,5 t	4,2 t	3 t	3,36 t	2,4 t
4 t	grey	4 t	3,2 t	8 t	5,6 t	4 t	2,8 t	2,0 t	5,6 t	4 t	4,48 t	3,2 t
5 t	red	5 t	4,0 t	10 t	7,0 t	5 t	3,5 t	2,5 t	7,0 t	5 t	5,60 t	4,0 t

\*inclination angle  $\beta$  reduces the WLL. Inclination angles over 60° are not permitted.

\*\* The load hoisting factor takes into account the change in WLL due to the sling type.

Overview of items

Order No.	Main colour	B	H	L1	Permissible load kg
07798-0100005	violet	47	12	0,5 m	1000
07798-0100010	violet	47	12	1 m	1000
07798-0100015	violet	47	12	1,5 m	1000
07798-0100020	violet	47	12	2 m	1000
07798-0100025	violet	47	12	2,5 m	1000
07798-0100030	violet	47	12	3 m	1000
07798-0100040	violet	47	12	4 m	1000
07798-0100050	violet	47	12	5 m	1000
07798-0200005	green	48	18	0,5 m	2000
07798-0200010	green	48	18	1 m	2000
07798-0200015	green	48	18	1,5 m	2000
07798-0200020	green	48	18	2 m	2000
07798-0200025	green	48	18	2,5 m	2000
07798-0200030	green	48	18	3 m	2000
07798-0200040	green	48	18	4 m	2000
07798-0200050	green	48	18	5 m	2000
07798-0300005	yellow	54	20	0,5 m	3000
07798-0300010	yellow	54	20	1 m	3000
07798-0300015	yellow	54	20	1,5 m	3000
07798-0300020	yellow	54	20	2 m	3000
07798-0300025	yellow	54	20	2,5 m	3000
07798-0300030	yellow	54	20	3 m	3000
07798-0300040	yellow	54	20	4 m	3000
07798-0300050	yellow	54	20	5 m	3000
07798-0400005	grey	70	22	0,5 m	4000
07798-0400010	grey	70	22	1 m	4000
07798-0400015	grey	70	22	1,5 m	4000
07798-0400020	grey	70	22	2 m	4000
07798-0400025	grey	70	22	2,5 m	4000
07798-0400030	grey	70	22	3 m	4000
07798-0400040	grey	70	22	4 m	4000
07798-0400050	grey	70	22	5 m	4000
07798-0500005	red	72	28	0,5 m	5000
07798-0500010	red	72	28	1 m	5000
07798-0500015	red	72	28	1,5 m	5000

## Overview of items

Order No.	Main colour	B	H	L1	Permissible load kg
07798-0500020	red	72	28	2 m	5000
07798-0500025	red	72	28	2,5 m	5000
07798-0500030	red	72	28	3 m	5000
07798-0500040	red	72	28	4 m	5000
07798-0500050	red	72	28	5 m	5000